

SOLIROC MÉTAL Products installation

Mounting plate

- 1- Floor installation – Vinyl or Lino
- 2- Floor installation - Carpeting
- 3- New construction - Wall rough-in
- 4- New construction – Utility by pass
- 5- Existing construction – Finished wall
- 6- Location for your Inlet Valve
- 7- Connecting to Mounting Plate

1- FLOOR INSTALLATION – VINYL OR LINO

Cut hole (2 3/8" by 4 3/8") into floor at desired location and screw mounting plate from below to underside of floor. Connect tube to mounting plate with a short 90" ell (Stock No. 2004-HXH)

Connect low-voltage wire to lugs on Inlet Valve and screw Inlet Valve into place.



Illustration 1

2- FLOOR INSTALLATION - CARPETING

Connect coupling (Stock No. 2010-HXH) to mounting plate. Insert a 1" sleeve of tube (shown as dotted line) between coupling and short 90" ell. Connect to tube. Repeat step "B" of fig. 1.

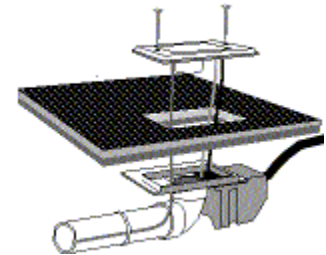

Illustration 2

3- NEW CONSTRUCTION – WALL ROUGH-IN

Cut 2 1/2" hole dead center through bottom plate and floor with the edge of the hole 1/4" from stud. Push tube through opening from below. Nail 1041 mounting plate at desired height with plaster-guard facing room. Push tube through opening from below. Connect tube with a short 90" ell to mounting plate, using the increments for proper 90" alignment.

Bend low-voltage wire behind mounting plate, leaving enough length to permit future connection to lugs on the Inlet Valve. Strap low-voltage wire to tubing with cable ties.

A temporary cardboard dust-cover is available to prevent construction debris entering the installed system. The dust-cover may be imprinted with the name or corporate logo of the installing company.

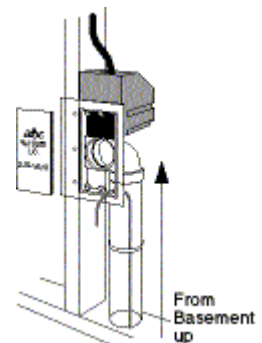
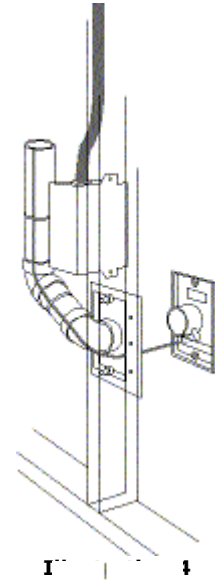

Illustration 3

4- NEW CONSTRUCTION - UTILITY BY PASS

Install mounting plates at desired location, slip a short 90" ell over the spigot projecting from the back of the mounting plate. Use the 45" increments on back of mounting plate and line up with the 45" increment on the short 90" ell for true 45" alignment. Insert a 2 1/4" pipe sleeve and slip into a 45" ell (Stock No. 2008-HXH) again using the 45" increments for proper 45" alignment. Insert pipe into upper hub of 45" ell. Repeat Step "B" of Fig. 1.



5- EXISTING CONSTRUCTION – FINISHED WALL

Cut mounting plate along dotted line with hacksaw or score with razor knife and break flange off. Using the raised edge of mounting plate as template, scribe exact opening on wall and cut opening.



Illustration 5

6- LOCATION FOR YOUR INLET VALVE

To drill pilot hole, first establish the location for your Inlet Valve! To find an un-obstructed section in wall (between studs), tap with your finger on wallboard until it sounds hollow. Using a 1/8" drill bit, drill a pilot hole right through floor directly below the selected location and as close to the baseboards as possible. Insert a coat hanger wire or equivalent into hole so that it projects below floor boards. From underneath floor measure from coat hanger to center of 2" x 4" plate, allowing for thickness of baseboard and wall covering. Drill 2 1/2" hole directly in the center of 2" x 4".

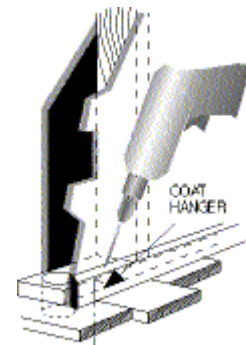
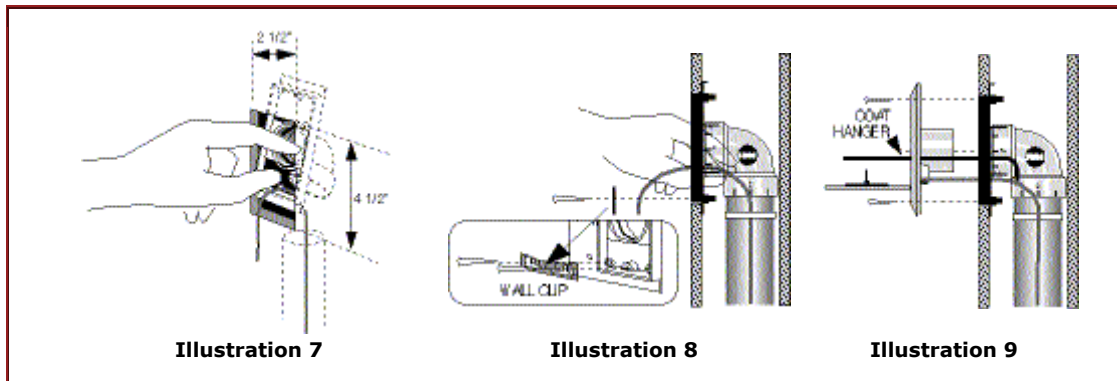

Illustration 6

7- CONNECTING TO MOUNTING PLATE

Slip short 90" ell over projecting spigot at back of mounting plate. Grasp mounting plate between forefinger, middle finger and thumb. Tit mounting plate top first upward into wall opening until completely inside wall.

Pull towards you until mounting plate fits snug into opening, and secure firmly in place with the use of the metal WALL CLIP, as shown in inset of illustration 8.



Connect low-voltage wire to lugs on back of Inlet Valve. Hold entire assembly in place with a coat hanger wire while twisting the Inlet valve onto the mounting plate. Do not glue, as rubber seal ring provides maximum air-tightness. Line up mounting-screw holes and screw Inlet Valve to mounting plate.

Note:

The use of the 90" eII (Stock No. 2004-HXH) is for 4" walls, while the Special Short 90" EII (Stock No. 2021-HXS) should be used for 3" walls.

Soliroc Métal inc.

8, chemin Vimy, C.P. 239
Coleraine, Québec
G0N 1B0

Téléphone : (418) 423.4986
Télécopieur : (418) 423.2288
Sans frais : 1.877.423.4986
Courriel : info@solirocmetal.com
Site Web : <http://www.solirocmetal.com>